

SITE PLAN
 LOTS 16-34 AND 16-35 OF SUNCADIA-PHASE 3, DIVISIONS 15 AND 16 (TUMBLE CREEK)
 WITHIN THE SE1/4 OF THE NW1/4 OF SECTION 14, TOWNSHIP 20 NORTH, RANGE 14 EAST, W.M., KITTITAS COUNTY, WASHINGTON

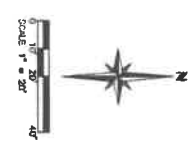

LEGEND

	EASEMENT
	BOUNDARY LINE

LOTS 16-34 AND 16-35

LOT 16-34	77,286 SQ. FT.
LOT 16-35	77,286 SQ. FT.

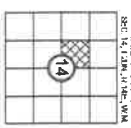

VERTICAL CURVE:
 THE VERTICAL CURVE INFORMATION IS FOR INFORMATION ONLY. THE VERTICAL CURVE DATA IS NOT TO BE USED FOR DESIGN OR CONSTRUCTION PURPOSES. THE VERTICAL CURVE DATA IS FOR INFORMATION ONLY.

CONTOUR INTERVAL: 1 FOOT
 THE CONTOUR INTERVAL IS 1 FOOT. THE CONTOUR INTERVAL IS 1 FOOT. THE CONTOUR INTERVAL IS 1 FOOT.

PROJECT BENCHMARK:
 THE PROJECT BENCHMARK IS THE CORNER OF LOT 16-34. THE PROJECT BENCHMARK IS THE CORNER OF LOT 16-34.

GENERAL NOTES:
 1. THE PURPOSE OF THIS SURVEY IS TO SHOW THE BOUNDARIES OF LOTS 16-34 AND 16-35 OF SUNCADIA-PHASE 3, DIVISIONS 15 AND 16 (TUMBLE CREEK) WITHIN THE SE1/4 OF THE NW1/4 OF SECTION 14, TOWNSHIP 20 NORTH, RANGE 14 EAST, W.M., KITTITAS COUNTY, WASHINGTON.
 2. THIS SURVEY WAS CONDUCTED IN ACCORDANCE WITH THE SURVEYING ACT AND THE RULES AND REGULATIONS OF THE BOARD OF SURVEYING AND MAPPING, KITTITAS COUNTY, WASHINGTON.
 3. THE SURVEY WAS CONDUCTED ON THE DATE OF 05/01/2021.
 4. ALL MONUMENTS SHOWN ON THIS PLAN WERE LOCATED DURING THE COURSE OF THIS SURVEY.
 5. THIS SURVEY WAS CONDUCTED WITHOUT THE BENEFIT OF A TITLE REPORT, EASEMENTS, ENCUMBRANCES AND RESTRICTIONS MAY EXIST ON THIS PROPERTY THAT ARE NOT SHOWN ON THIS PLAN.
 6. THE SURVEYOR HAS CONDUCTED A VISUAL INSPECTION OF THE PROPERTY AND HAS FOUND NO EVIDENCE OF EASEMENTS, ENCUMBRANCES OR RESTRICTIONS.
 7. THE SURVEYOR HAS CONDUCTED A VISUAL INSPECTION OF THE PROPERTY AND HAS FOUND NO EVIDENCE OF EASEMENTS, ENCUMBRANCES OR RESTRICTIONS.

REFERENCES:
 1. PLAN OF SURVEY PHASE 1, TOWNSHIP 20 NORTH, RANGE 14 EAST, W.M., KITTITAS COUNTY, WASHINGTON.
 2. PLAN OF SURVEY PHASE 2, TOWNSHIP 20 NORTH, RANGE 14 EAST, W.M., KITTITAS COUNTY, WASHINGTON.
 3. PLAN OF SURVEY PHASE 3, TOWNSHIP 20 NORTH, RANGE 14 EAST, W.M., KITTITAS COUNTY, WASHINGTON.

EXISTING LEGAL DESCRIPTIONS:
 1. LOT 16-34 OF SUNCADIA-PHASE 3, DIVISIONS 15 AND 16 (TUMBLE CREEK) WITHIN THE SE1/4 OF THE NW1/4 OF SECTION 14, TOWNSHIP 20 NORTH, RANGE 14 EAST, W.M., KITTITAS COUNTY, WASHINGTON.
 2. LOT 16-35 OF SUNCADIA-PHASE 3, DIVISIONS 15 AND 16 (TUMBLE CREEK) WITHIN THE SE1/4 OF THE NW1/4 OF SECTION 14, TOWNSHIP 20 NORTH, RANGE 14 EAST, W.M., KITTITAS COUNTY, WASHINGTON.

RESULTANT LEGAL DESCRIPTION:
 LOTS 16-34 AND 16-35 OF SUNCADIA-PHASE 3, DIVISIONS 15 AND 16 (TUMBLE CREEK) WITHIN THE SE1/4 OF THE NW1/4 OF SECTION 14, TOWNSHIP 20 NORTH, RANGE 14 EAST, W.M., KITTITAS COUNTY, WASHINGTON.

SHEET	SURVEYED BY: BH/AM	CHECKED BY: VN
	DRAWN BY: SM/SW	APPROVED BY: SW
1	DATE	REVISION
	BY	DATE
1		

SITE PLAN

TAX PARCELS NO. 961334 & 961335 - NHN GOLD LEAF LANE, CLE ELUM, WASHINGTON

FOR
 DAN KRESSBACH
 WASHINGTON

SCALE: 1"=20' DATE: 8/04/21 APSSM PROJECT NO.: 3186.002 ACAD NAME: 3185002SP.dwg

